



EXISTING SKYLIGHT

TOP COAT - 1 1/2 (1.50)
GALLONS PER 100
SQUARE FEET

BASE COAT - 1 1/2 (1.50)
GALLONS PER 100
SQUARE FEET

SPRAYABLE MASTIC
ENCAPSULATING
LABOR SAV'R, 1" MIN.
OVERLAP ALL SIDES

LABOR SAV'R EXTEND
2" MINIMUM UP WALL &
ONTO ROOF SURFACE

EXISTING 100 PSI
POLY-ISO ROOF
SURFACE

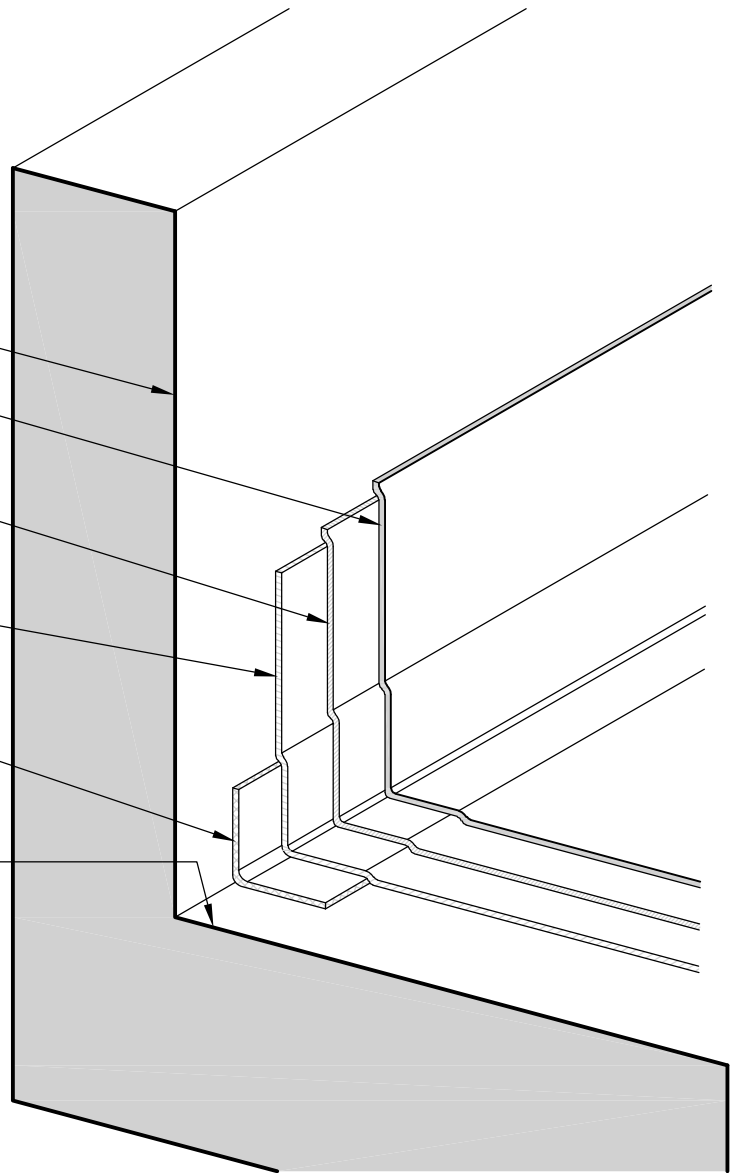

CORPORATE HEADQUARTERS

5020 ENTERPRISE PARKWAY
SEVILLE, OHIO 44273
PHONE: (800) 457-4056
FAX: (330) 769-4153

ELASTIKOTE APPLICATION AT SKYLIGHT

Detail for Application on Existing
100 PSI Poly-Iso Roofing Systems

DWG NO.

EK PI009