

HYLOAD WS FLASHING  
MEMBRANE AS SPEC.

HYBASE FLASHING PLY AS  
SPEC.

COVERBOARD INSUL . AS SPEC.

END LAP SPLICE STRIP 6" WIDTH - CENTER  
OVER END LAPS OF FLASHING AND HOT AIR  
WELD EACH SIDE

30" SQUARE MIN., 4 LB. LEAD OR 16 OZ.  
COPPER FLASHING SET ON FINISHED ROOF  
IN ROOF CEMENT, PRIME TOP SURFACE  
BEFORE STRIPPING

DRAIN STRAINER AS SPEC.

THERMAL INSUL. AS SPEC.

HYBASE SAM INTERPLY SHEET  
AS SPEC.

BASE SHEET AS SPEC.  
IF REQUIRED

EXISTING/ NEW ROOF DECK

CLAMPING RING AS SPEC.

DECK CLAMP AS SPEC.

DRAIN BOWL AS SPEC.

MEMBRANE FIELD PLIES, METAL FLASHING,  
AND STRIPPING PLIES ALL EXTEND UNDER  
CLAMPING RING

ROOF CEMENT AS SPEC.

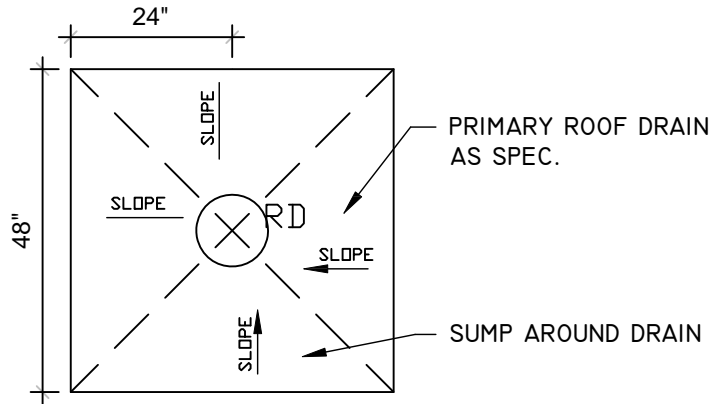
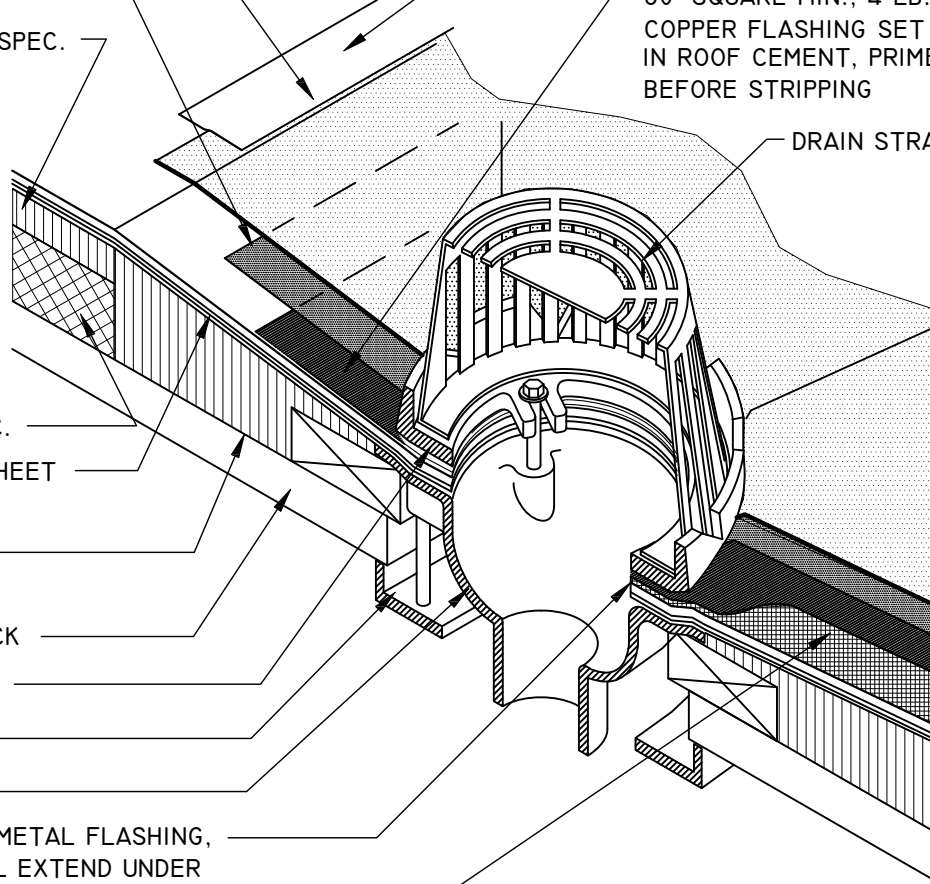

**HyTOP™**  
Total Overhead Protection

## AREA ROOF DRAIN

CORPORATE HEADQUARTERS

5020 ENTERPRISE PARKWAY  
SEVILLE, OHIO 44273  
PHONE: (800) 457-4056  
FAX: (330) 769-4153

DWG NO.

**SA004**