

SEPARATE PIPES FROM
OTHER PIPES 12" MIN.
EXTEND PIPES 8" MIN.
BEYOND OUTSIDE WALL
BEFORE ELBOW, 'Y' OR
OTHER CHANGES

- HYPROOF WATERPROOFING MEMBRANE
- FIRST PLY SHEET
- SECOND PLY SHEET
- THIRD PLY SHEET
- 3/4" HYLOAD STRUCTURAL SEALANT OR TROWEL-ON MEMBRANE FILLET
- COMPRESSION BAND W/ HYLOAD WATERPROOFING MASTIC APPLIED FLASHING

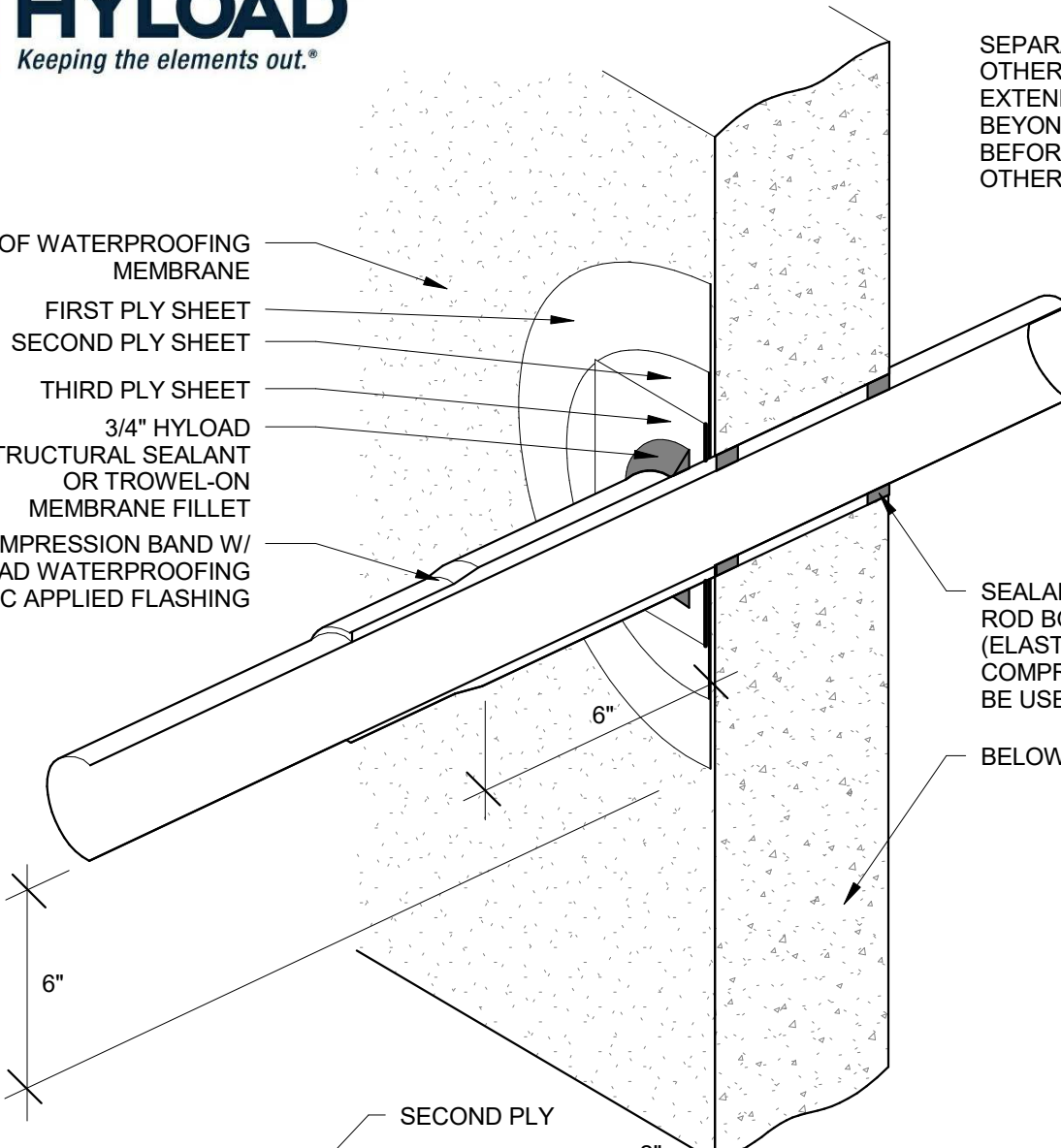

- SEALANT AND BACKER ROD BOTH SIDES (ELASTOMERIC COMPRESSION SEAL MAY BE USED)
- BELOW GRADE WALL

