

HYLOAD WS FLASHING
MEMBRANE AS SPEC.

HYBASE FLASHING PLY AS
SPEC.

COVERBOARD INSUL . AS SPEC.

END LAP SPLICE STRIP 6" WIDTH - CENTER
OVER END LAPS OF FLASHING AND HOT AIR
WELD EACH SIDE

30" SQUARE MIN., 4 LB. LEAD OR 16 OZ.
COPPER FLASHING SET ON FINISHED ROOF
IN ROOF CEMENT, PRIME TOP SURFACE
BEFORE STRIPPING

DRAIN STRAINER AS SPEC.

THERMAL INSUL. AS SPEC.

HYBASE SAM INTERPLY SHEET
AS SPEC.

BASE SHEET AS SPEC.
IF REQUIRED

EXISTING/ NEW ROOF DECK

CLAMPING RING AS SPEC.

DECK CLAMP AS SPEC.

DRAIN BOWL AS SPEC.

MEMBRANE FIELD PLIES, METAL FLASHING,
AND STRIPPING PLIES ALL EXTEND UNDER
CLAMPING RING

ROOF CEMENT AS SPEC.

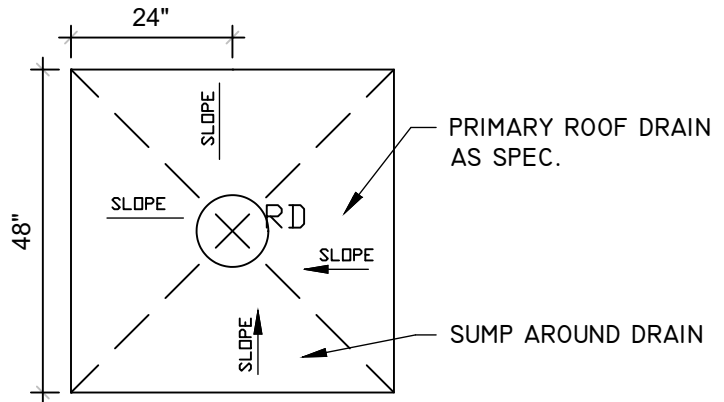
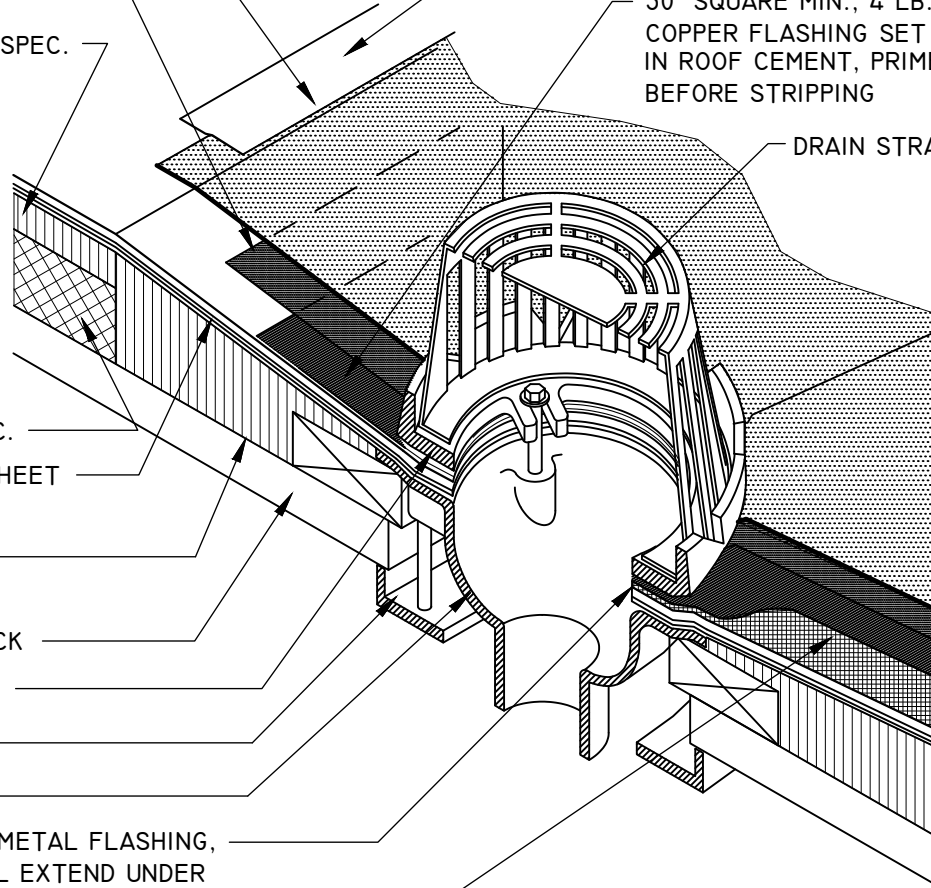

AREA ROOF DRAIN

CORPORATE HEADQUARTERS

5020 ENTERPRISE PARKWAY
SEVILLE, OHIO 44273
PHONE: (800) 457-4056
FAX: (330) 769-4153

DWG NO.

SA004

